

Soils Map

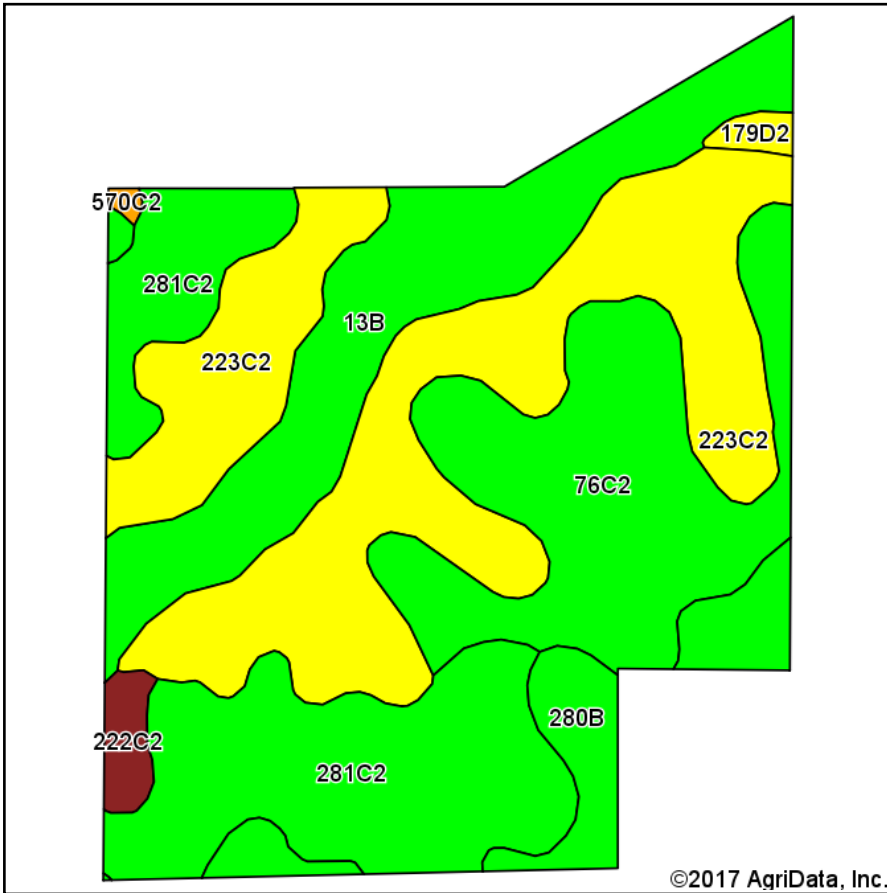

Soils data provided by USDA and NRCS.

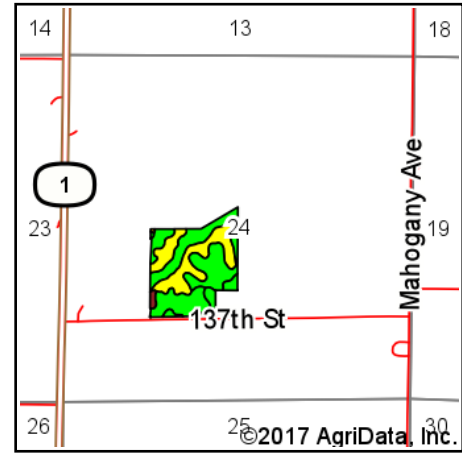

State: **Iowa**
 County: **Jefferson**
 Location: **24-73N-10W**
 Township: **Black Hawk**
 Acres: **40.45**
 Date: **2/7/2017**



Maps Provided By:



© AgriData, Inc. 2017

www.AgriDataInc.com



Area Symbol: IA101, Soil Area Version: 24

Code	Soil Description	Acres	Percent of field	CSR2 Legend	Non-Irr Class *c	CSR2**	CSR
223C2	Rinda silty clay loam, 5 to 9 percent slopes, moderately eroded	13.06	32.3%		IVw	45	22
281C2	Otley silty clay loam, 5 to 9 percent slopes, eroded	8.88	22.0%		IIIe	82	70
76C2	Ladoga silty clay loam, 5 to 9 percent slopes, eroded	8.18	20.2%		IIIe	75	65
13B	Olmitz-Vesser-Zook complex, 0 to 5 percent slopes	6.72	16.6%		IIw	74	60
280B	Mahaska silty clay loam, 2 to 5 percent slopes	2.72	6.7%		Ile	89	90
222C2	Clarinda silty clay loam, 5 to 9 percent slopes, moderately eroded	0.55	1.4%		IVw	34	25
179D2	Gara clay loam, 9 to 14 percent slopes, moderately eroded	0.26	0.6%		IVe	45	43
570C2	Nira silty clay loam, 5 to 9 percent slopes, moderately eroded	0.08	0.2%		IIIe	70	67
Weighted Average						66.9	52.4

Area Symbol: IA101, Soil Area Version: 24

**IA has updated the CSR values for each county to CSR2.

*c: Using Capabilities Class Dominant Condition Aggregation Method

Soils data provided by USDA and NRCS.